

CERTIFIED RECORD OF LAND CORNER MONUMENTATION

History of original corner establishment:

The original corner was established in 1883 by Henry W. Cooke.

Set a basalt stone 18x12x10 ins. 12 ins in the ground for cor to secs 5,6,31 & 32 marked with 5 notches on the E. and 1 notch on the West edges dug pits 18x18x12 ins in each Sec. 5 1/2 ft dist and raised a mound of earth 2 ft high and 4 1/2 ft base alongside.

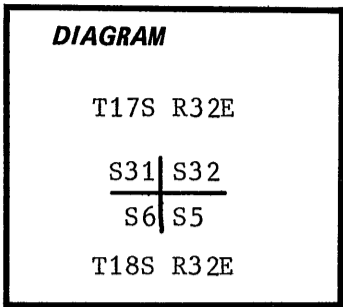

Description of corner evidence found:

Found a 16x11x8 lava stone, firmly set, no markings visible. The position of this stone agrees very well in distance and direction with the original record measurements to the quarter corner and section corner to the East, and is approximately 1 chain long in distance and good in direction with the section corner to the North.

Description of monument and accessories established to perpetuate the original location of this corner:

Set a 3 1/2" x 30" USDA aluminum monument with magnet 22" in the ground and buried the original stone alongside.

CAP MARKED

Set a 2" aluminum cap on rebar N 45 E, 25.0 feet stamped T17S R32E S32 RM S45W 25.0 PLS 1918 1985.

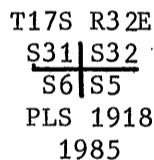

Set a 2" aluminum cap on rebar N 45 W, 25.0 feet stamped T17S R32E S31 RM S45E 25.0 PLS 1918 1985.

Set a 2" aluminum cap on rebar S 45 W, 25.0 feet stamped T18S R32E S6 RM N45E 25.0 PLS 1918 1985.

Set a 2" aluminum cap on rebar S 45 E, 25.0 feet stamped T18S R32E S5 RM N45W 25.0 PLS 1918 1985.

Set a Steel fence post North 3 feet with Attention sign.

Work performed 19 May 1985  
Witness: Louise H. Parsons

Tyler B. Parsons, PLS 1918  
1915 SE Stone Street  
Corvallis, OR 97333  
(503) 752-7515

Road Cadastral Survey, Cont No 53-04H1-4-9665N

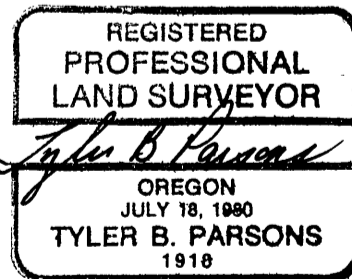

Office of Surveyor County of Grant  
 State of Oregon, I hereby certify that the within instrument was filed in this office  
 for record on the 19 day of June, 1985  
Robert D. Baggett by \_\_\_\_\_  
 (COUNTY OFFICIAL) (DEPUTY)